

TTB CAMLOK BIG BAG LIFTERS

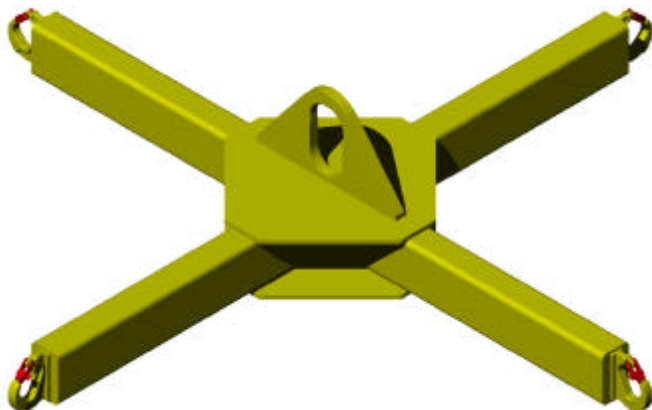

Model	WLL Kg	Working Width mm	Weight Kg	Price £
TTB 1/1090	1000	750-800	27	
TTB 1/1320	1000	900-970	33	
TTB 2/1090	2000	750-800	42	
TTB 2/1320	2000	900-970	52	



- The TTB Big Bag Spreader Beam has been designed to lift and transport big bags safely and securely.
- It is manufactured as a 4 point fixed frame of welded construction incorporating 4 hooks and safety latches which allow fast loading and unloading.

Also available in stainless steel for use in the food industry etc.
Price on application. Contact sales for further details.

TZH CAMLOK ADJUSTABLE TINE HOOK

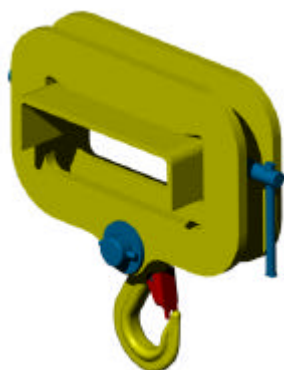

Model	WLL Kg	Max Fork Size mm	Weight Kg	Price £
TZH 1.5/150	1500	100-150	8.5	
TZH 3/150	3000	100-150	12	
TZH 5/150	5000	100-150	16	
TZH 5/200	5000	150-200	22	
TZH 10/200	10000	150-200	43	

- Designed for fastening hoisting equipment and load to fork lift tines.
- Easily attached via 2 spindles.
- The hook pivots and swivels ensuring a safe lift.

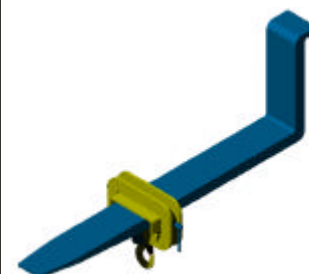

FLTH CAMLOK ADJUSTABLE DUAL TINE HOOK

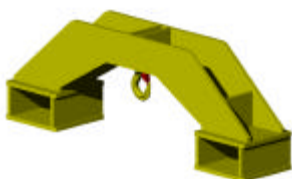

Model	WLL Kg	Max Fork Size mm	Weight Kg	Price £
FLTH 1	1000	120X60	25	
FLTH 2	2000	120X60	37	

- Designed to fit on to any point on the forks.
- Supplied as standard with a safety hook.
- Hook can be replaced with a chain and sling.
- Other sizes are available on request.

